

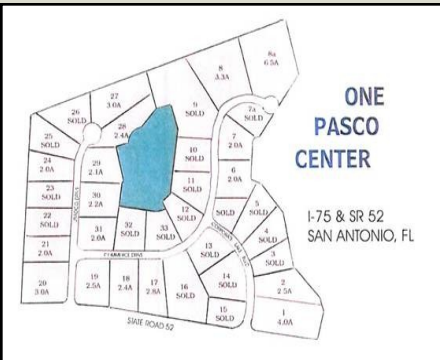

One Pasco Center

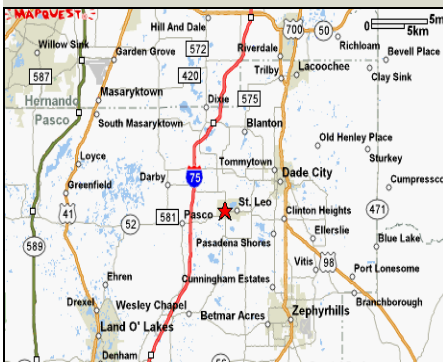

Located on State Road 52, one-half mile from the I-75 and State Road 52 interchange in north central Pasco, One Pasco Center is zoned for mixed uses such as commercial, light industrial and hotel. The park consists of lots varying in size from two to six acres. One Pasco Center has a master drainage system with sanitary sewer and water service provided by Pasco County. The electric provider is Withlacoochee River Electric Cooperative. The park maintains an on-going speculative building program.



Contact: Pasco Economic Development Council
 16506 Pointe Village Drive, Suite 101
 Lutz, Florida 33558
 (813) 926-0827
 info@pascoedc.com